

Barbed Basic Side Port Pkgs.

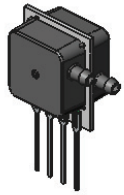

H1, H1E
Barbed Basic Side Port
D1 Porting SIP
(Standard)

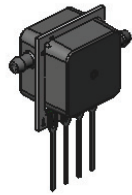

H2, H2E
Barbed Basic Side Port
D2 Porting SIP
(Standard)

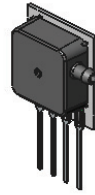

HG, HGE
Barbed Basic Side Port
G Porting SIP
(Standard)

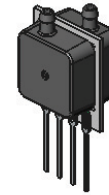

HT, HTE
Barbed Basic Side Port
Top Porting SIP
(Custom)

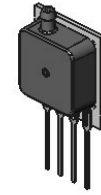

HL, HLE
Barbed Basic Side Port
G-Top Porting SIP
(Custom)

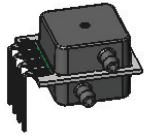

H1R, H1RE
Barbed Basic Side Port
D1 Porting RA SIP
(Semi-Custom)

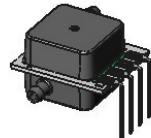

H2R, H2RE
Barbed Basic Side Port
D2 Porting RA SIP
(Semi-Custom)

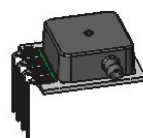

HGR, HGRE
Barbed Basic Side Port
G Porting RA SIP
(Semi-Custom)

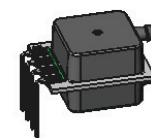

HTR, HTR
Barbed Basic Side Port
Top Porting RA SIP
(Custom)

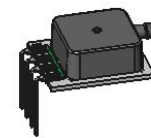

HLR, HLR
Barbed Basic Side Port
G-Top Porting RA SIP
(Custom)

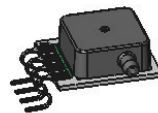

HGQ, HGQE
Barbed Basic Side Port
G Porting Single S-Bend
(Semi-Custom)

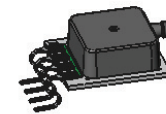

HLQ, HLQE
Barbed Basic Side Port
G-Top Porting Single S-Bend
(Custom)

NOTES:

"E" extension indicates Epoxy lid attach, otherwise RTV lid attach. e.g. H1R (RTV), H1RE (Epoxy)

Standard: Local Stock Delivery

Semi-Custom: Local Stock, Local Customization (Customization charges may apply)

Custom: Overseas Customization (Longer lead times, customization charges and minimum lot size may apply)

Full-Custom: Additional Tooling Required (Longer lead times, tooling charges and minimum lot size may apply)

ALL SENSORS

FILE NAME

H-Package Series Rev A